

- Notes
- 1 For ease of handling during testing stages, fitting of side drop flap item 39, sliding insert item 40 and rear drop flap item 42 can be deferred until packaging assembly stage.
 - 2 Fit battery cable harness item 14 and route past the cylindrical post in the base moulding - see detail 'C'. Ensure that the tubular inductor is positioned in the space between the cylindrical post and the main PCB.
 - 3 Solder switch item 60 to cable harness item 14 and then snap into base moulding; orange wire connects to switch centre contact, yellow wire to switch end contact.
 - 4 Connect display cableform item 23 to LCD status display item 35 and bend pins through 90° so that the connector is bent tightly back against the back of the status display - see detail 'A'. Remove release paper, affix insulator item 37, remove protective film from status display, and insert with status display window item 24 into base moulding.
 - 5 Route sleeved portion of display cableform along the battery compartment channel; route the remaining length behind/below the battery connector housing and then past the cylindrical post in the base moulding - see detail 'C'. Secure battery connector housing and both cables in place using the clamp plate item 17 and screw item 31. Do not overtighten screw.
 - 6 Secure screw locks item 56 in eight positions and nuts item 59 in two positions using thread-locking adhesive item 76 - see detail 'G'.
 - 7 Affix stand-off pads item 66 to main PCB insulator sheet item 16 in positions shown in detail 'D'.
 - 8 Affix insulating tape item 71 cut to approx. 10mm x 10mm to rear wall moulding item 48 in three positions, to hold collared nuts item 26 in place.
 - 9 Ensure that the links on the floppy disc drive item 73 are set to the "MODE 1" position - see detail 'E'.
 - 10 Cut foam strip item 44 to 15mm length and affix to "V" notch in case upper moulding (part of display panel assembly item 4) - see detail 'F'.
 - 11 Remove flying lead (if fitted) from DC/DC converter board item 18 prior to assembly.
 - 12 After inserting flex-cables from display panel item 4 into main PCB connectors, bend cables down above surface of main PCB to relieve cable bend radius through hinge assembly.
 - 13 Check that the battery pack fits securely into the battery compartment - if necessary, adjust the bump lock on the underside of the keyboard item 6 so that the battery pack clicks home positively with its end face just sub-flush to the base moulding.

IF IN DOUBT ASK

THIRD ANGLE
PROJECTION

DO NOT SCALE

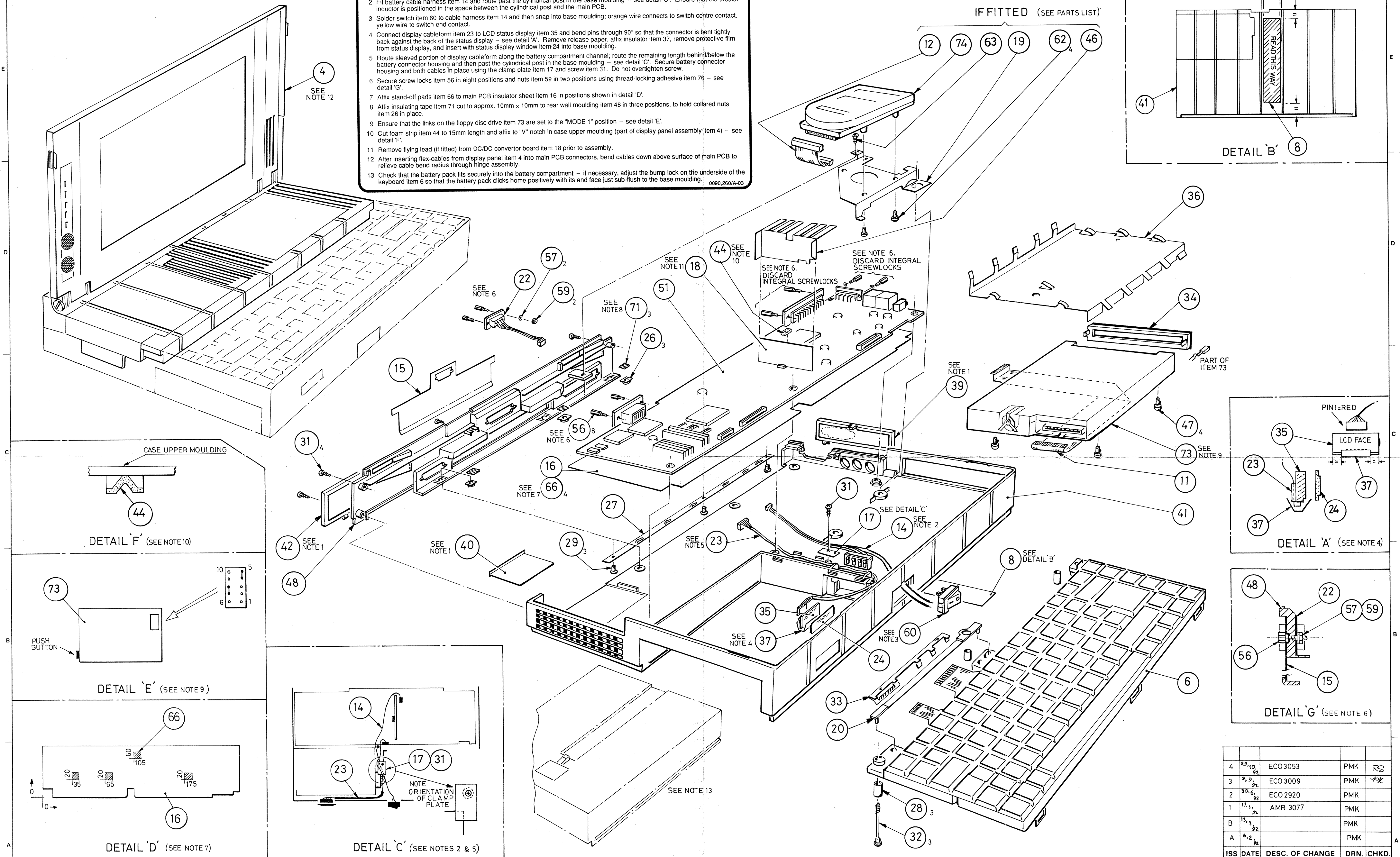

SCALE	N.T.S.	ALL DIMENSIONS IN mm UNLESS OTHERWISE STATED
MATERIAL	SEE APPROPRIATE PARTS LIST	
FINISH		
WHOLE No. TOL.	±1mm	DECIMAL No. TOL.
		ANGLE TOL.

Copyright of this drawing is reserved by ACORN COMPUTERS LTD. It is issued on condition that it is not copied, reproduced or disclosed to a third party, either wholly or in part, without the consent in writing of ACORN COMPUTERS LTD.



© COPYRIGHT 1992
ACORN COMPUTERS LTD
FULBURN ROAD
CHERRY HINTON
CAMBRIDGE
CB1 4JN

TITLE

A4
FINAL ASSEMBLY (ALL VARIANTS)

ACORN COMPUTERS Ltd

A1

DRG. No. 0090,260/A

ISS	DATE	DESC. OF CHANGE	DRN.	CHKD.
4	29.10.92	ECO 3053	PMK	RS
3	9.9.92	ECO 3009	PMK	RS
2	30.6.92	ECO 2920	PMK	
1	17.1.92	AMR 3077	PMK	
B	13.3.92		PMK	
A	6.2.92		PMK	